

IARMOR EDGE™

PART#: IA-N133

BEFORE INSTALLATION

REMOVE CONTENTS FROM BOX. VERIFY ALL PARTS ARE PRESENT. READ INSTRUCTIONS CAREFULLY BEFORE STARTING INSTALLATION. ASSISTANCE IS RECOMMENDED. THANK YOU FOR CHOOSING OUR PRODUCT!

*DRILLING NOT REQUIRED / CUTTING IS REQUIRED

*TRIMMING NOT REQUIRED

Fastener Size	Tightening Torque (ft-lbs)	Required
6mm	6-7	√
8mm	16-18	√
10mm	31-32	√
12mm	56-58	X
14mm	92-94	X

Item	QTY	Description	Item	QTY	Description
1#	2	Driver Front & Rear Mounting Brackets	10#	8	M8X1.25-30mm Hex Bolts
2#	2	Passenger Front & Rear Mounting Brackets	11#	8	M8 Lock Washers
3#	2	Driver Front & Rear Support Brackets	12#	12	M8 Large Flat Washers
4#	2	Passenger Front & Rear Support Brackets	13#	4	M8 Hex Nuts
5#	4	M10 Bolt / M8 Nut Plates	14#	8	M6X1-20mm Square Head Bolts
6#	4	M10 Plastic Washers	15#	32	M6X1-20mm T-Bolts
7#	4	M10 Large Flat Washers	16#	40	M6 Large Flat Washers
8#	4	M10 Lock Washers	17#	40	M6 Nylon Lock Nuts
9#	4	M10 Hex Nuts			

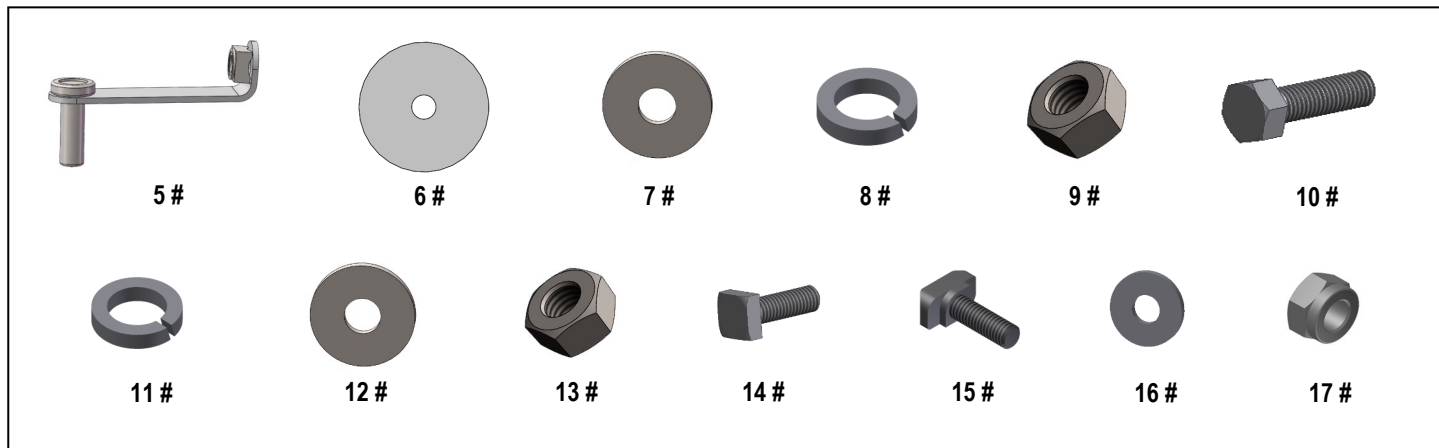

iArmor[®]

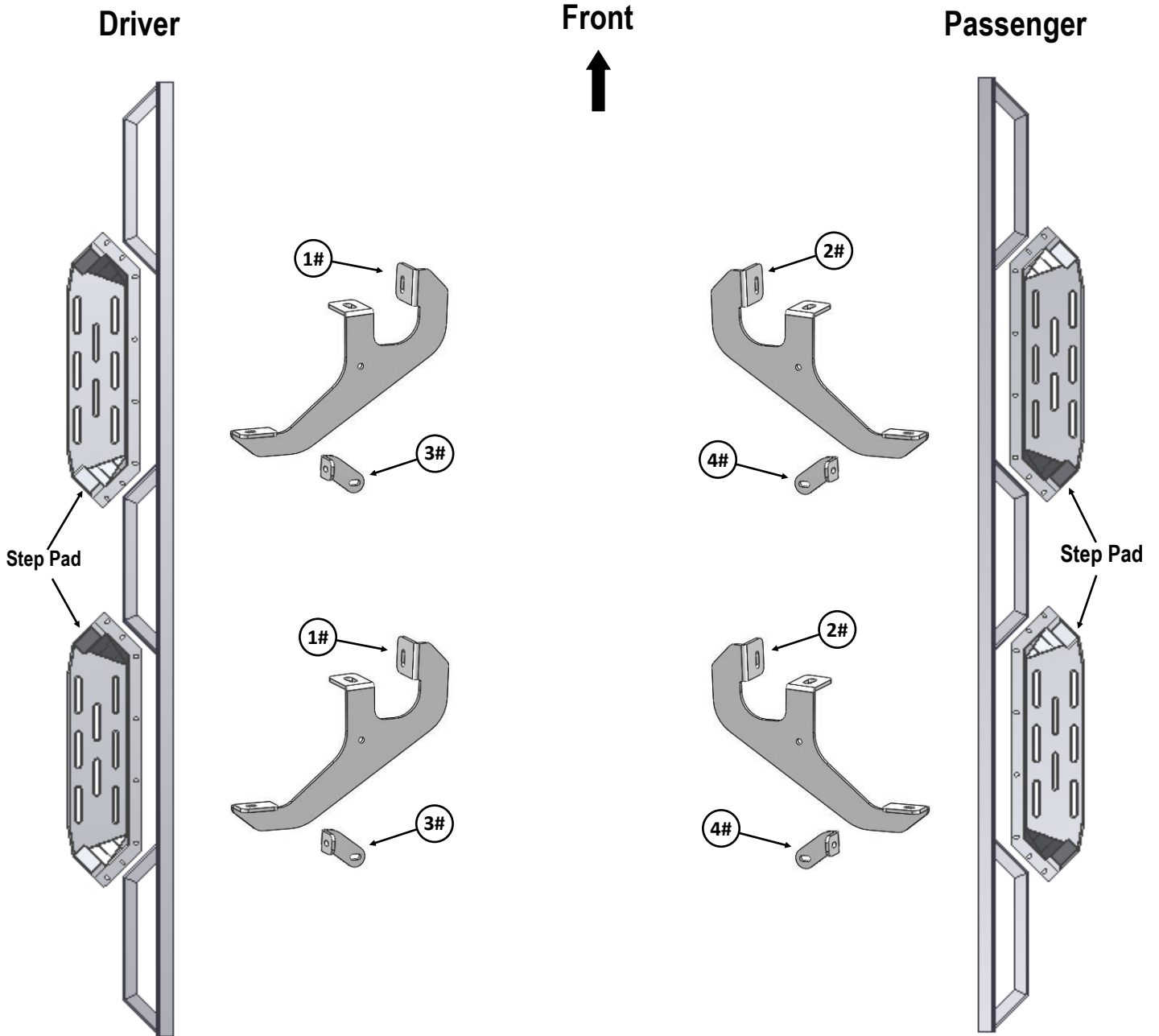

iArmor®

The instruction here is for your reference only. We strongly recommend the professional installer for best result. We are not responsible for any damage caused by the installation.

STEP 1

Install the Step Pads onto the step bars with (32) M6x1-20mm T-Bolts, (32) M6 Flat Washers and (32) M6 Nylon Lock Nuts.

IMPORTANT: Don't hit the step pad by any metal hammer within step pad installation, or the step pad will be damaged.

(8) M6X1-20mm T-Bolts
(8) M6 Flat Washers
(8) M6 Nylon Lock Nuts

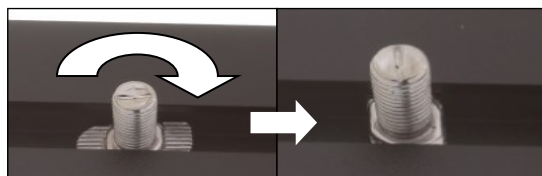

Note: Rotate 90° after inserting the T-Bolts into the Channel!!!

STEP 2

Start installation from the driver side of the vehicle. Locate the factory holes at the bottom and inner side of the floor panel, (Fig 1).

IMPORTANT: On some vehicles, the body panel may be filled with expanding foam insulation. Clear out the foam inside the mounting holes, (Fig 2).

Use These (2) Holes. Remove Foam As Necessary

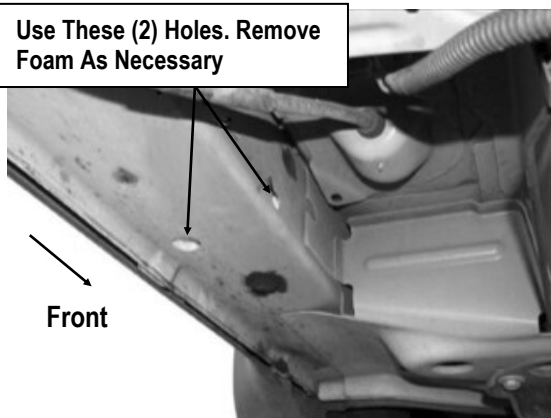

(Fig 1) Driver Side Front Mounting Location

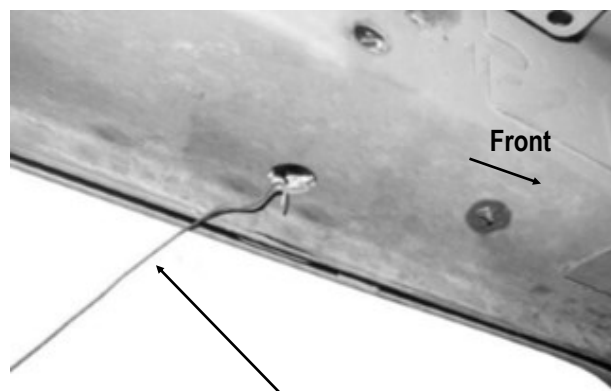

(Fig 2) Clear Out The Foam In The Mounting Holes (Use Wire To Pull Foam From Floor Panel)

STEP 3

Select (1) M10 Bolt / M8 Nut Plate. Insert the bent end with the 8mm nut into the hole in the bottom of the floor panel, (Fig 3). Line up the hex nut with the hole in the side of the floor panel. Thread (1) M10 Plastic Washer onto the M10 Bolt end of the Bolt /Nut Plate, (Fig 3). **NOTE:** The Plastic Washer is provided to hold the Bolt /Nut Plate in position during Bracket installation.

iArmor®

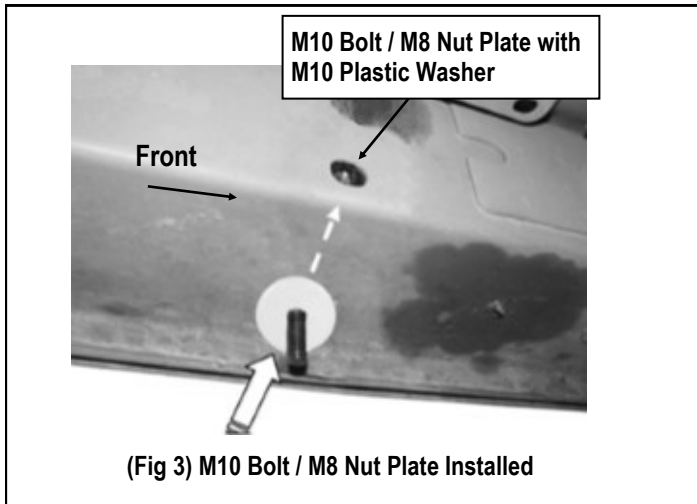

STEP 4

Select (1) Driver Front Mounting Bracket and Driver Front Support Bracket, assemble with (1) M8x1.25-30mm Hex Bolt, (2) M8 Large Flat Washers (1) M8 Lock Washer and (1) M8 Hex Nut, (Fig 4). Do not fully tighten hardware at this time.

Attach the assembled Bracket to the installed M10 Bolt with (1) M10 Large Flat Washer, (1) M10 Lock Washer and (1) M10 Hex Nut. Attach the Bracket to the M8 Nut with (1) M8x1.25-30mm Hex Bolt, (1) M8 Lock Washer and (1) M8 Large Flat Washer, (Fig 4). Do not fully tighten hardware at this time.

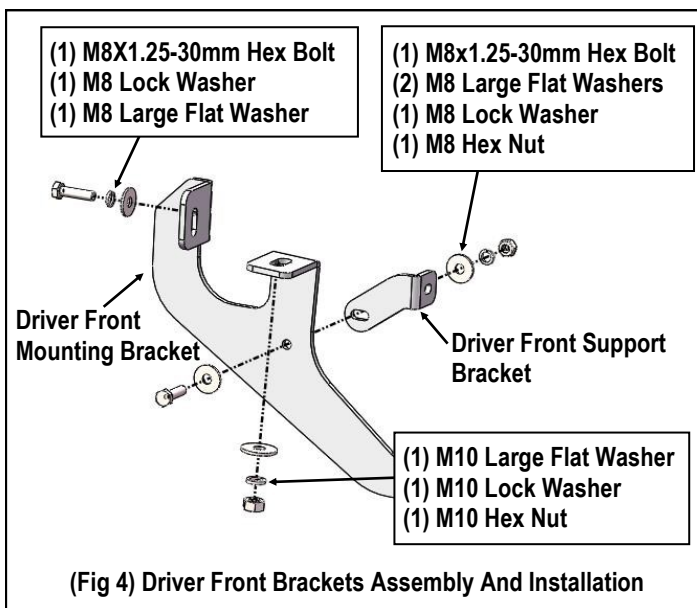

STEP 5

Move to the Driver Side Rear Mounting Location of the vehicle. Locate the round hole in the bottom of the floor panel as described in **Step 2, (Fig 5)**. Repeat **Steps 3 – 4** to install the Driver Rear Mounting Bracket and Driver Rear Support Bracket in the rear location.

Note: Driver Front & Rear Mounting Brackets are universal.
Driver Front & Rear Support Brackets are universal.

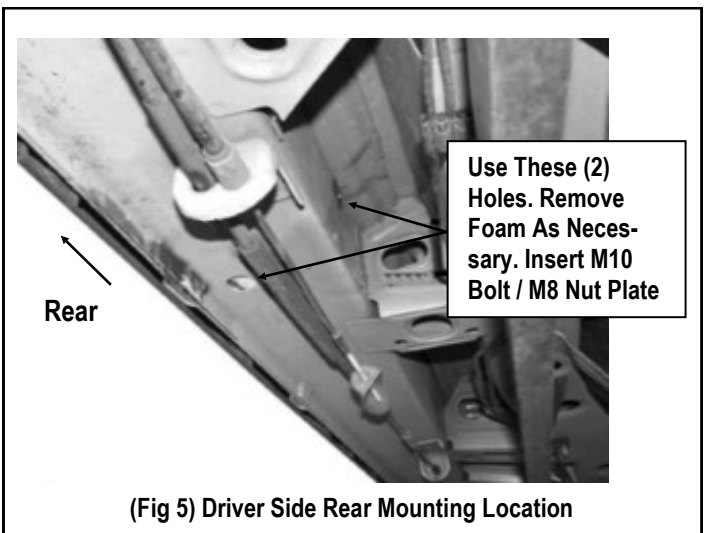

STEP 6

Once all (2) Driver side mounting brackets are installed, select and attach the Driver Side Step Bar onto the Mounting Brackets with (4) M6X1-20mm Square Head Bolts, (4) M6 Large Flat Washers and (4) M6 Nylon Lock Nuts, (Fig 6). Do not fully tighten hardware at this time.

STEP 7

Properly level and adjust the Step Bar and fully tighten all hardware.

iArmor®

STEP 8

Move to the other side of the vehicle. Repeat **Steps 1—7** for other side Step Bar installation.

Attention

Do periodic inspections to the installation to make sure that all hardware is secure and tight.
In order to protect your bars/boards, please use only mild soap/non-abrasive products for cleaning.

(Fig 6) Driver Side Step Bar Installation

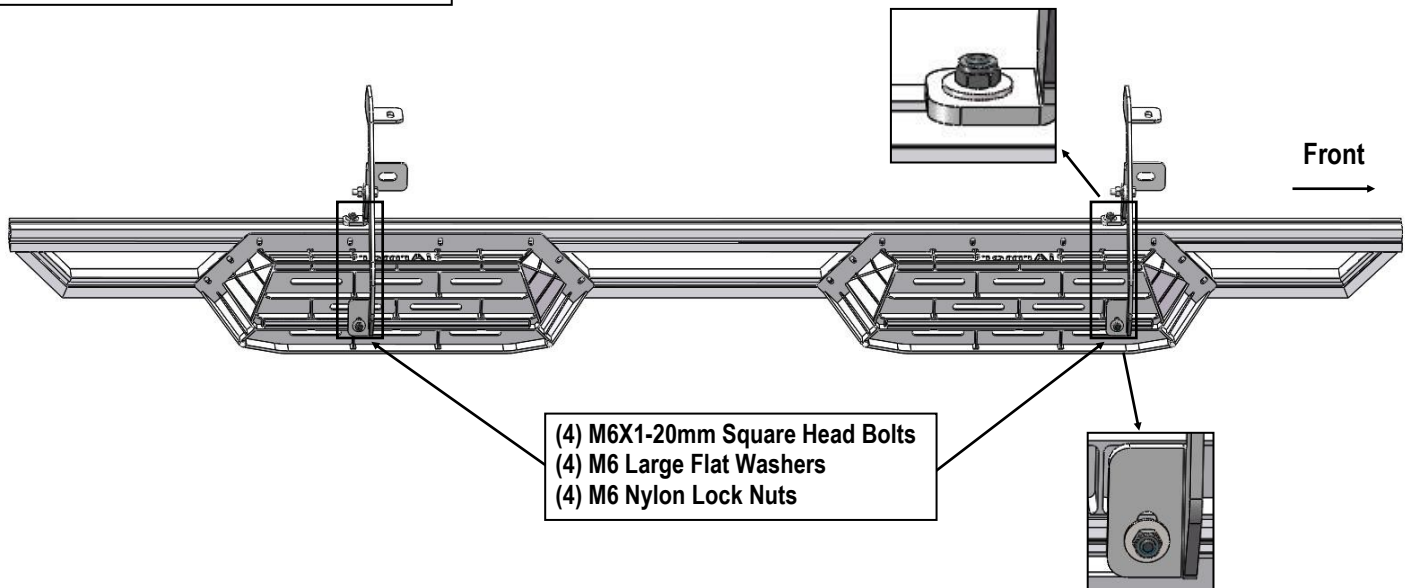

Warning: Install the T-bolt on the step bar and rotate it to 90 degrees!!!